

Torque Transducer (static)

Type DF-30

○ Both ends with flange



Dimensions in mm

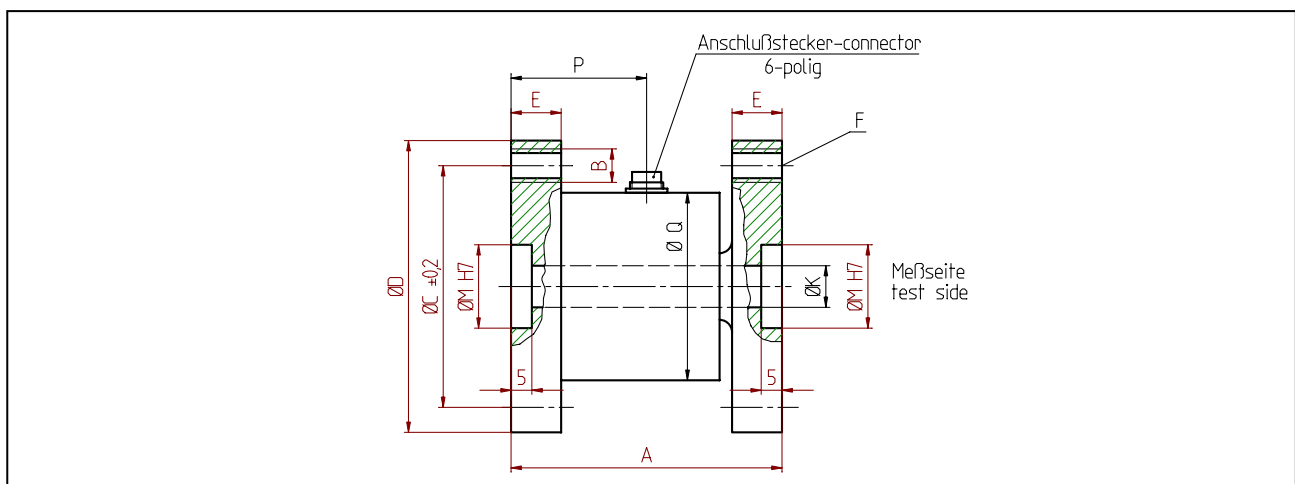

Ranges [Nm]	A	B	ØC	ØD	E	F	ØM	ØK	P	ØQ
10 ¹⁾ ; 25; 50; 100; 200	65	M 8	58	70	12	6x60°	20	10	33	45
500; 1 000	80	M 10	82	100	15	8x45°	20	18	39,5	60
2 000	100	M 12	100	130	20	12x30°	75	20	45	80
5 000	100	M 12	100	130	20	12x30°	75	-	45	80
10 000; 20 000	124	M24	210	260	32	8x45°	105	105	67,5	145

Specifications

Type	DF-30	
accuracy class	% v.E	0,2
sensitivity (S)	mV/V	1,00
service torque	% v.E	130
limit torque	% v.E	150
ultimate torque	% v.E	> 300
max. dyn. load	% v.E	70
bridge resistance	Ω	350
excitation voltage	V	2 ... 12
nominal temp. range	°C	-5 ... +45
service temp. range	°C	-15 ... +55
twist angle by nominal load	°	<0,2
level of protection (DIN 40 050)	IP 50	
connector	6 pol	

options:

accuracy class	% v.E	0,1
calibration control	S%	100
Sensorinterface Typ LCV	0-10V or 0(4) - 20 mA	LCVU or LCVI

¹⁾ Range 10 Nm only 0,5 mV/V